

HM-200DTC-A 规格书 (FeedThrough Filter 馈通滤波器)

1. Outline Drawing and Dimensions:(mm)

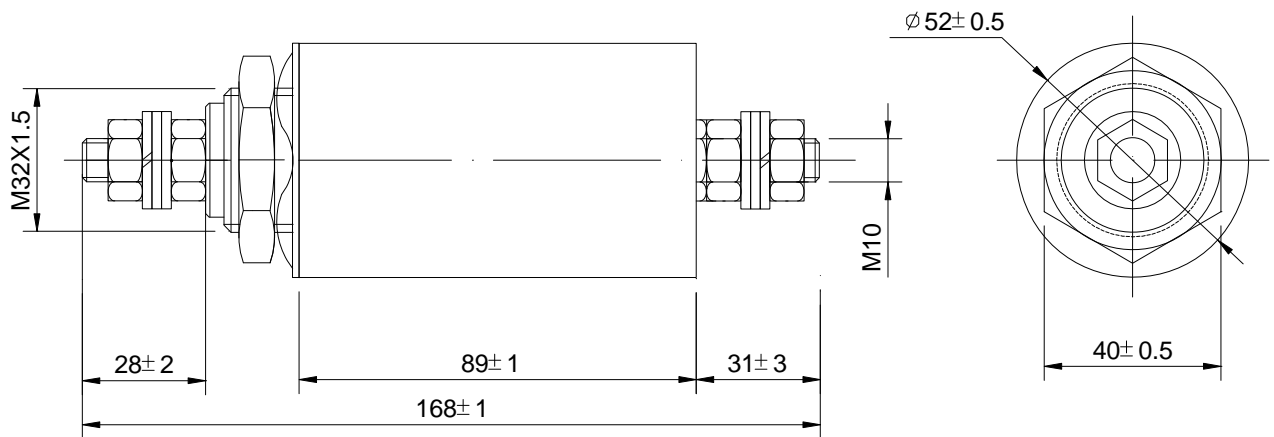

2. Specification:

Rated Voltage: 250VAC /400VDC

Rated Current: 200A

Operating frequency: 50/60Hz

Test Voltage(1min): 2100VDC

Climatic Category: 40/085/56

3. Circuit Diagram:

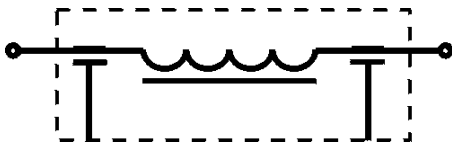

$$C=2 \times 4.7 \mu F \pm 20\%$$

4. Insertion Loss in dB: (Measured in 50Ω system)

